



BUILDING A LEGACY OF COMPASSIONATE CARE

New Port Richey Health Center Naming Opportunities

LOBBY:

- ~~Reception - \$25,000~~ **RESERVED**
- ~~Pharmacy - \$25,000~~ **RESERVED**
- ~~Patient Education - \$10,000~~ **RESERVED**
Patient Education - Site Administration - \$10,000
- ~~Break Room - \$10,000~~ **RESERVED**
- ~~Patient Education - Comm. Services Rooms - \$5,000~~ **RESERVED**
Patient Education - Offices - \$5,000 (3 Available)
- ~~Employee Workroom - \$5,000~~ **RESERVED**
- ~~Pharmacist Office - \$5,000~~ **RESERVED**

BEHAVIORAL HEALTH:

- ~~Pediatric Waiting Room - \$10,000~~ **RESERVED**
- ~~Adult Waiting Room - \$10,000~~ **RESERVED**
- ~~Triage (Child) - \$7,500~~ **RESERVED**
Triage (Adult) - \$7,500 (1 Available)
- ~~Reception - \$7,500~~ **RESERVED**
- ~~Medical Management (Child) - \$5,000~~ **RESERVED**
- ~~Medical Management (Adult) - \$5,000~~ **RESERVED**
Counselor (Child) Room - \$5,000 (2 Available)
Counselor (Adult) Room - \$5,000 (1 Available)

PEDIATRICS:

- ~~MA Station - \$15,000~~ **RESERVED**
Lab - \$15,000
- ~~Waiting Rooms - \$12,500~~ **RESERVED**
- ~~Reception - \$5,000~~ **RESERVED**
Exam Rooms - \$5,000 (3 Available)
- ~~Doctor Office - \$5,000~~ **RESERVED**
- ~~Triage - \$5,000~~ **RESERVED**

DENTISTRY:

- Xray Room - \$20,000
- Lab - \$15,000
- ~~Reception - \$10,000~~ **RESERVED**
- ~~Pediatric Waiting Area - \$10,000~~ **RESERVED**
- ~~Adult Waiting Area - \$10,000~~ **RESERVED**
- ~~Sterilization - \$10,000~~ **RESERVED**
Doctor Office - \$5,000
Adult Exam Rooms - \$5,000 (2 Available)
Pediatric Exam Rooms - \$5,000 (6 Available)

PRIMARY CARE:

- ~~Waiting Rooms - \$15,000~~ **RESERVED**
Reception - \$12,500
Triage - \$10,000
Nurses Stations - \$10,000 (1 Available)
Meds - \$7,500
- ~~Exam - \$5,000~~ **RESERVED**

WOMENS HEALTH:

- ~~Reception - \$15,000~~ **RESERVED**
- ~~Waiting Room - \$15,000~~ **RESERVED**
MA Workstation - \$7,500 (2 Available)
Lab - \$15,000
Exam Room - \$5,000 (5 Available)
Doctor's Office - \$5,000 **RESERVED**

PHLEBOTOMY:

- Lab - \$25,000
- Waiting Room - \$10,000

Whole Suite Available: \$35,000

All donation levels are welcome. Donors who make a gift of \$1,000+ will be included on the Legacy Wall. All donations less than \$5,000 are vital to the campaign and will support the new medical equipment, start up supplies and health center furnishings.



BUILDING A LEGACY OF COMPASSIONATE CARE

New Port Richey Health Center Naming Opportunities

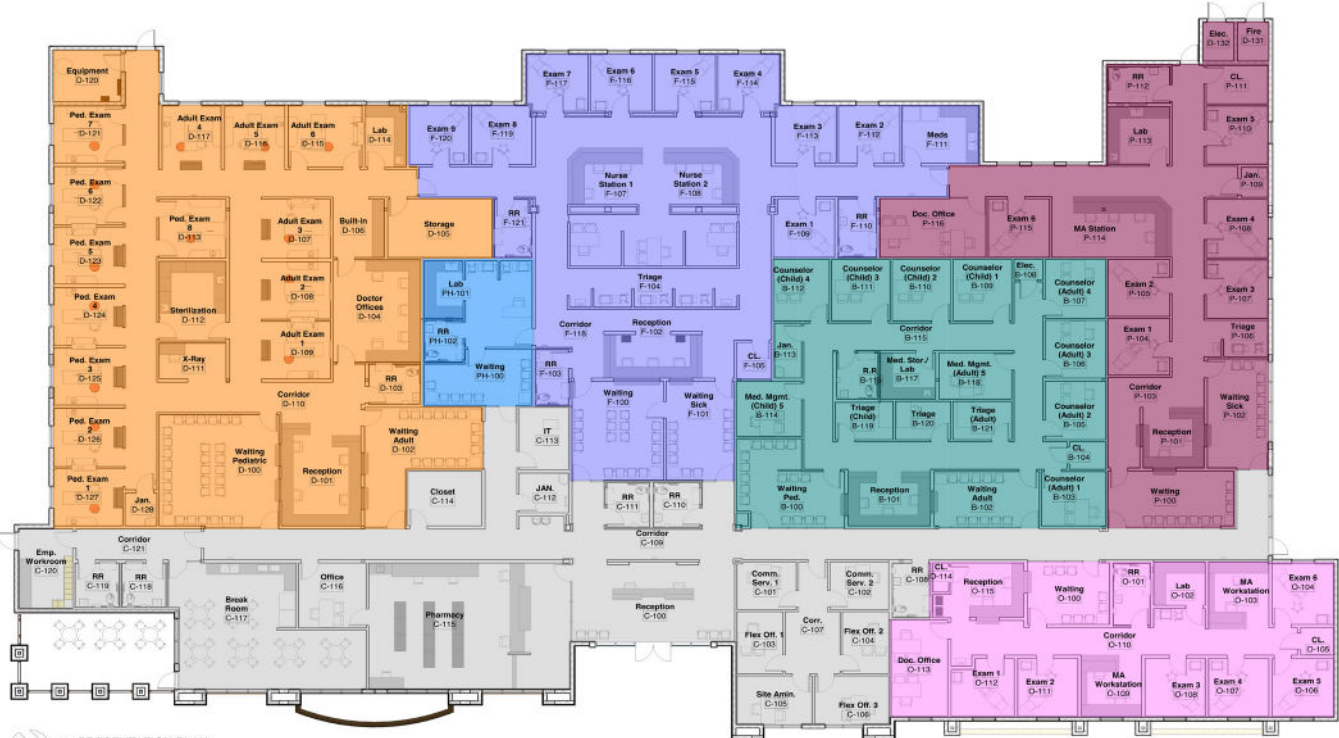

1 PRESENTATION PLAN
1/8" = 1'-0"

- Dentistry
- Primary Care
- Obstetrics/
Gynecology
- Pediatrics
- Behavioral Health
- Lobby Area
- Phlebotomy

